

# Slide Clear- S40 Folding Door

Adptable Concealed Hinges - Minimal Frame



The S40 Folding Door system is our European designed, concealed hinge folding door series. This system can act as an adaptable partition door system, barrier wall or divider for areas where thermal values are less important but a superior seal and weather defense is still required. The panels neatly fold away, allowing for a connected unified space in the indoors or out.

**Application** Patios, verandas, balconies, bars, greenhouses, restaurants, hotels, shopping malls, pool areas, hot tub surrounds, etc.

**Dimensions** Custom made door panels up to 39-3/8" (1000mm) in width and systems up to 120" (3048mm) in height. The S40 Folding Door system has an unlimited width span with various configurations to choose from.

**Sliding** The door panels run on a top and bottom track. The door panels on the S40 system are suspended from the top track by synthetic roller carriages and guided in the bottom track using synthetic rollers.

**Closure** Easy, quick and silent. Door panels can be folded together on the left or right only, or on both sides for larger openings. The closed panels occupy a space of about 9% of the systems total width.

**Adjustments** The side jambs and upper/lower tracks provide up to 5/16" (8mm) of adjustment.

**Features** The hinges on the S40 Folding Door System are completely concealed inside the stiles. This helps to enhance the overall visual appearance of the door system, while increasing the door systems weather resistance. The S40 system also features removable hinge pins for easy cleaning. Intermediate support rails may be required on panels above 7' tall (2100mm).

## Specifications

<b>Operation</b>	Top Hung
<b>Direction</b>	In Swing or Out Swing
<b>Thermally Broken</b>	No
<b>Max Panel Weight</b>	110lbs (50kg)
<b>Standard Glazing</b>	3/4" (20mm) IGU
<b>Single Pane Specs.</b>	3-1/16"- 5/16" (4-8mm)
<b>Double Pane Specs.</b>	5/8"-15/16" (16-24mm)
<b>Max Panel Width</b>	39-3/8" (1000mm)
<b>Max System Width</b>	26'-3" (8000mm)
<b>Max System Height</b>	120" (3048mm)

## Color Options

<b>Standard Colors</b>	Clear Anodized
	RAL 9006 White Aluminum
	RAL 9010 Pure White
	RAL 9016 White
	RAL 1013 Linen
	RAL 8017 Brown
<b>Custom Colors</b>	RAL 7035 Light Grey
	Please contact for quote
<b>Hardware Colors</b>	Black and Silver
	<i>*Hardware includes handles, locks, rollers and guides</i>

# S40 Folding Door

## Options

<b>Bottom Threshold Options</b>	Weather Defense Sill
	Low Threshold Sill
	Flush Threshold Sill
<b>Lock Options</b>	1-Point Lock *Standard Below 7' (2134mm)
	3-Point Lock *Standard Above 7' (2134mm)

## Delivery

Standard 8-12 week delivery
FOB: Surrey BC, Canada
Freight to be quoted

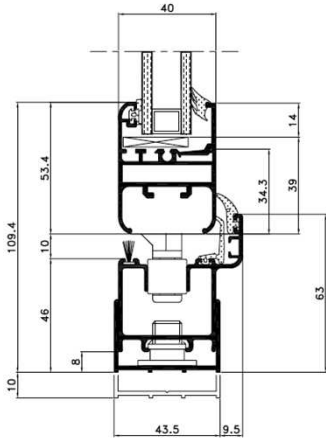

Weather Defense Sill

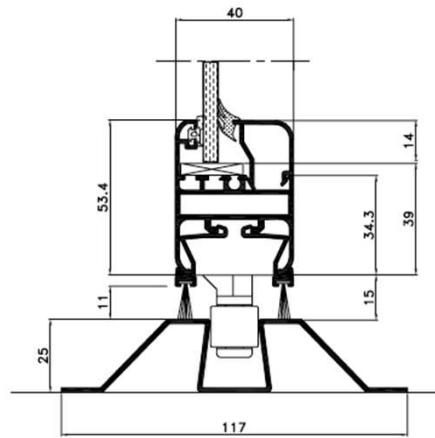

Low Sill

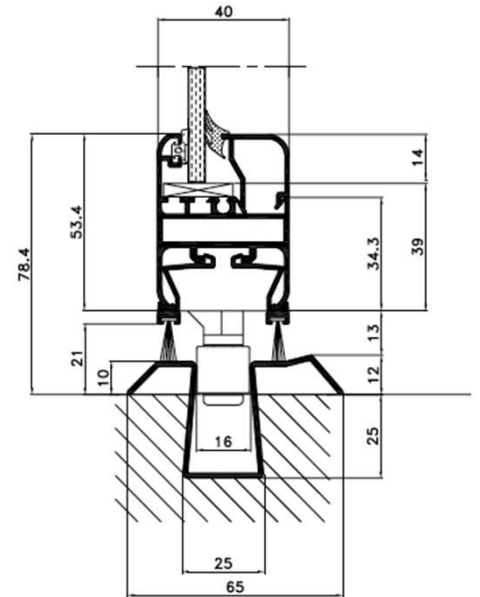

Flush Sill

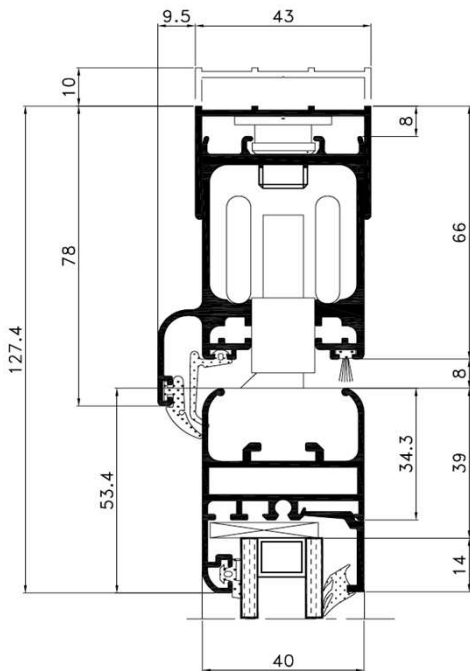

Sectional View (Top Track)

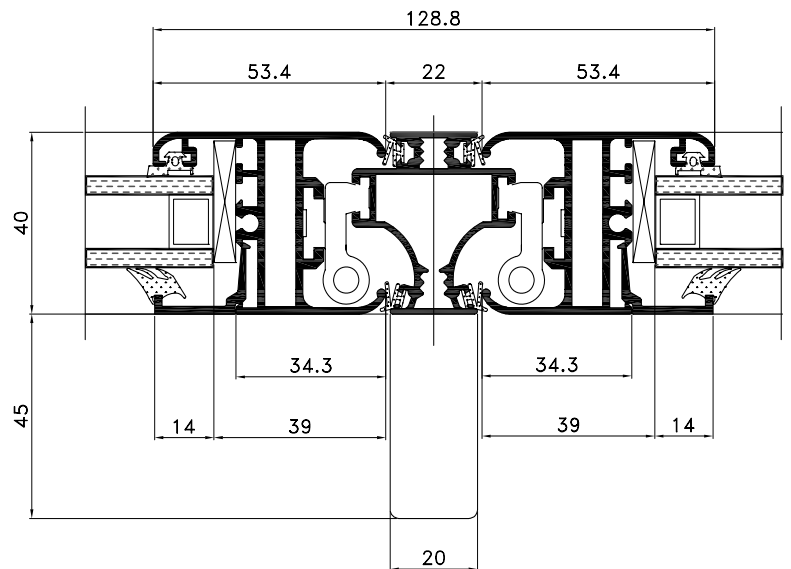

Sectional View (Stile)